



*Eye On The World*

# PHOTOGRAM

Monthly Newsletter of the Redlands Camera Club

## September 2021

Photogram Editor – Debra Dorothy  
Deadline for entries is the 25th of every month

Redlands Camera Club meets: 1<sup>st</sup> & 3<sup>rd</sup> Mondays, 7:00 pm

Check <http://www.redlandscameraclub.com> for Zoom meetings

***Guests are always welcome***



*Photo by Rick Strobaugh*

ColorMunki – Have your photos submitted for QuickPix, Members' Night, or competitions not looked the way you expected? The problem is probably a difference in how your computer and the club projector display colors and brightness. You can fix this by calibrating your computer the same way our club calibrates our projector – with the ColorMunki. Set up is simple and the calibration process only takes a few minutes. Contact Carl Detrow at [csdetrow@verizon.net](mailto:csdetrow@verizon.net) to reserve the ColorMunki.

---

Want to learn more about your hobby?  
Click the link below to go to ***B&H learning Video Site:***

Click [HERE](#)

## President's Message – Russell Trozera



This month some of the members of Redlands Camera Club participated in the 12<sup>th</sup> Annual Community Photo Show 2021 hosted by Redlands Art Association at the RAA Gallery & Art Center in downtown Redlands. The following members posted their works in the gallery,

Stephanie Billings, Bruce Herwig II, Wayne Purcell, Debra Seibly, Judith Sparhawk, Rich Strobaugh and Russell Trozera Purcell. The following art work was displayed at the gallery.



*Photos by Deborah Seibly*





*Photo*  
*by*  
*Bruce Herwig*



*Photos*  
*by*  
*Russell Trozera*





*Photo*  
*by*  
*Judith Sparhawk*



*Photo by Wayne Purcell*



*Photos*

*by*

*Stephanie Billings*





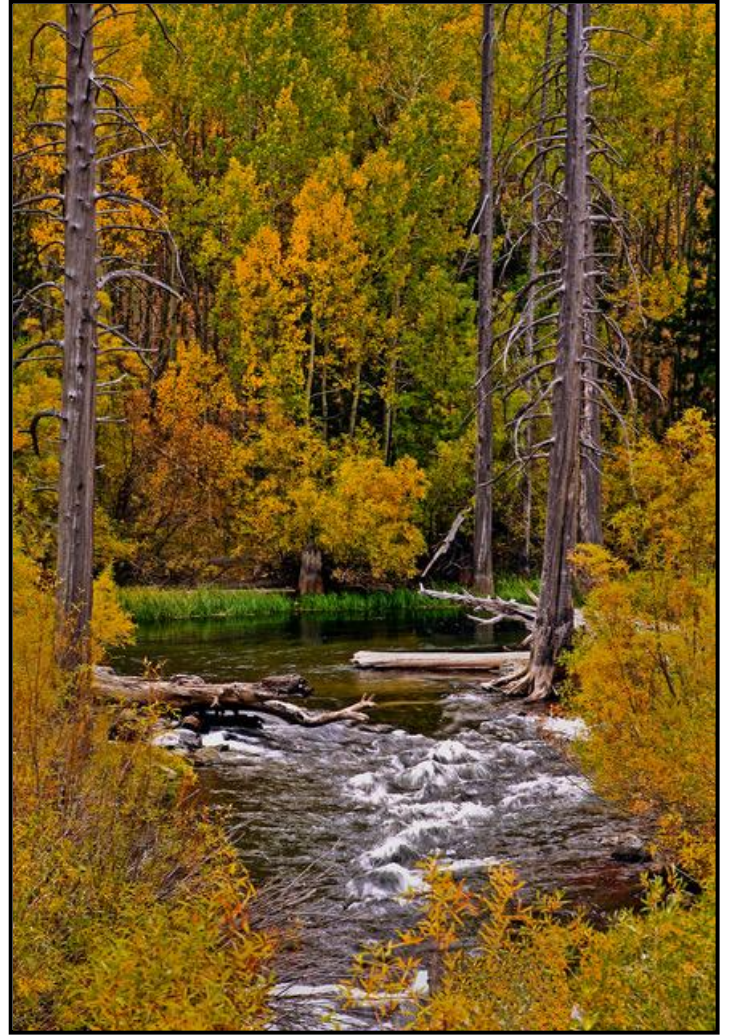
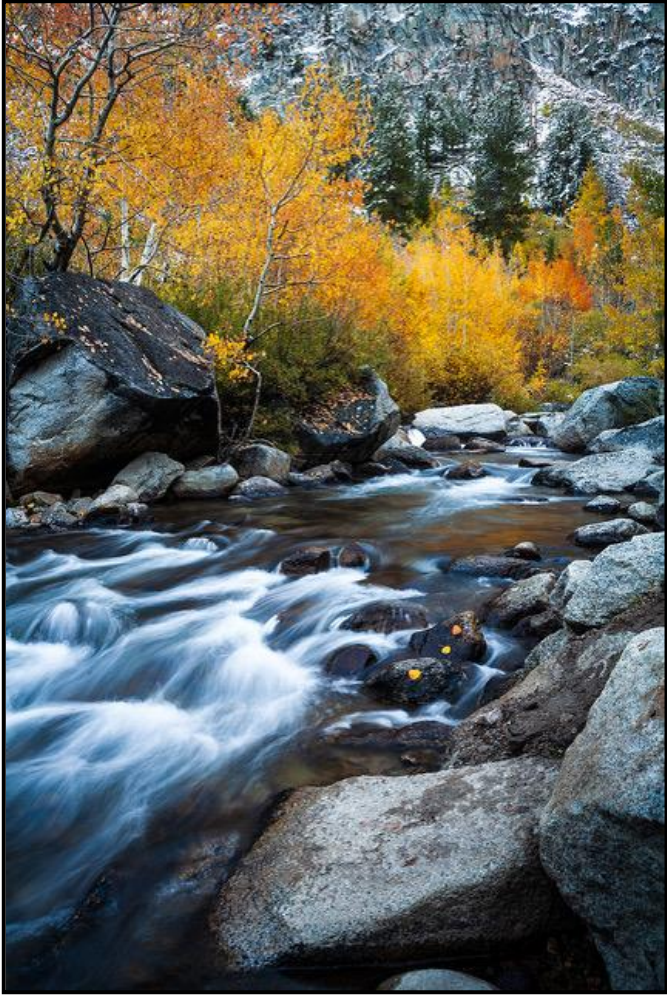

*Photo by Russell Trozera*

**Photogram Theme "Nature"**



*Photos by Rick Strobaugh*



*Photos by Rick Strobaugh*







*Photos by Debra  
Dorothy*



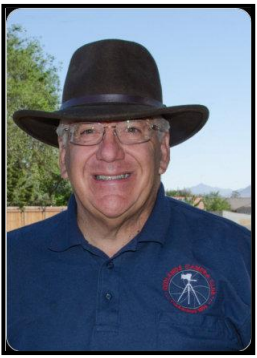

*Photos by  
Russell Trozera*





## Competition Chair – Carl Detrow

### Competition

2021 Winter Competition

Our next competition is planned for Monday, December 6, 2021, on Zoom.

Entries will be accepted on the website from November 3-17. Awards will be presented on December 20. Cost is \$10 for 1 or 2 images, collected on PayPal during the entry process.

Competition categories are listed on the website. Category X for this competition will be "Reflections."  
Carl Detrow

---

*Photo by Russell Trozera*



*Photo by Debra Dorothy*



## Mentoring Chair – Rick Strobaugh



### Including People in your Photos

In many situations with landscape or travel photos, we are looking at not having people in our photos but there are many times when a person or people in the photo will add to the photo or make more of a personal contact with the viewer.

In a landscape, including a person can help give a reference scale to how big the trees, rock formations, cliffs or area is. The trick is making sure they are easily seen and look natural. The subject wearing bright colored clothing or silhouetted against a brighter area, helps.

I once shot a mountain when two hikers stopped at a viewpoint. The grey mountainside behind them made them impossible to even see, so I quickly moved my position by about 50 yards to where they were now silhouetted in front of a white patch of snow on the mountainside behind them. Having someone on a trail or viewing a scene from behind, makes the viewer feel like that could be them right there.

In travel photo scenes, people in the scene can give the scene more life, showing the normal activity to that spot rather than deserted. Another nice effect is to shoot the scene in low light or with a neutral density filter to make the scene much darker with a slower shutter speed. Still expose for the buildings, fountains or street scene to be well exposed. The movement of people in the scene will now be blurred movement or, can completely eliminate most people moving thru the scene. People standing still will show up in the photo. You will need a tripod to accomplish this.

Do keep in mind that any photos that you are going to sell or enter into many competitions, you will need a signed Model Release form for anyone that is identifiable in the photo. That is again why, a view from the back will often be better. You can also be the person in the scene yourself by using your 10 second timer, giving you time to get into a nearby position, or use a remote shutter release for further positioning. Just make sure your tripod and camera are in a solid position or someone else securing it.

Example Image



*Photo by Rick Strobaugh*



## Upcoming events

Redlands Camera Club is having a photo walk in Redlands celebrating 125 years since the founding of the Club in 1896. "Why I Love Redlands" is the theme of the photo walk. Photo walk will begin at Smiley Park in Redlands at 9 AM Oct. 2, 2020. The public is invited to participate in this event.

Categories for the event are People, Places, Heritage and Miscellaneous related to Redlands.

### **1. "We Love Redlands " Community Photo Walk**

To help celebrate our beautiful city, the Redlands Camera Club is offering a community photo walk on State Street, Saturday, October 2, 2021

We will meet Smiley Park at 9:00am. A Redlands Camera Club member will lead you to some of the most photogenic areas on State Street. They will also be on hand to answer camera-related questions you might have.

Participants are encouraged to share their favorite images for showing at our Community Night

### **2. Redlands Photo Contest - Open to the public**

4 Categories -

People

Places

Heritage. (Related to Redlands)

Miscellaneous (Related to Redlands)

Overall Grand Prize, 1st, 2nd and 3rd Place Ribbons in each category

All ages welcome. Photos can be taken with any kind of camera....including, but not limited to a Smartphone, DSLR, mirrorless, film or drone.

Photos should be submitted no later than Midnight Tuesday October 12, 2021

No fee to enter. Only 1 photo per category, please.

Submit to [redlandscameraclub@gmail.com](mailto:redlandscameraclub@gmail.com)

### **3. Community Night at the Redlands Camera Club**

Come celebrate Redlands and photography as we look at photos from years past, photos from our walking tour, and celebrate the winners of our photo contest. Cake and punch to be served.

This Redlands Camera Club meeting is free and open to the public.

Monday, October 18 @ 7:00 pm

First Presbyterian Church 100 Cajon Street

Parking is on 4th Street, across the street from the Lincoln Memorial Shrine.

**Proposed Walking Tour and thoughts to photography forth coming.**

# 2021 Summer Competition

## 2nd Place Ribbons

[Click HERE for 1st Place Ribbons](#)  
[Click HERE for 3rd Place Ribbons](#)  
[Click HERE for Honorable Mention](#)



**Plum Blossom**  
Joseph Rosales



**Saved By The Bridge And Chain**  
Stephanie Billings

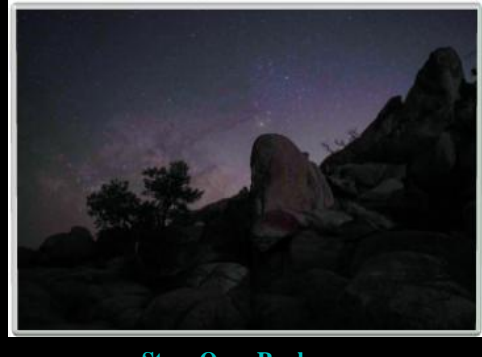

**Stars Over Rocks**  
Gary Fitch



**Salvation Street**  
Jim Hendon



**Snack Time**  
Debra Dorothy



**Bug And Bloom**  
Dennis Taylor

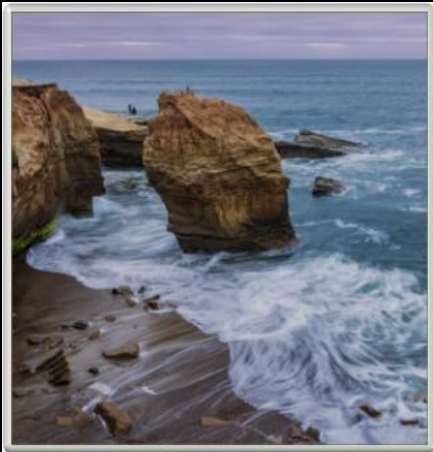

**Waves Sculpting The Shore**



**North Head Sunset**  
Bruce Bonnett

*Photo by Rick  
Scrobaugh*





**You are invited to an Iceland Photo Workshop  
By Robert Fletcher of Canon USA and Jeff Swinger of USA Today and Canon  
USA**

The workshop is geared towards waterfalls, Northern Lights, Glaciers, Ice Caves,  
Fjords, black beaches with 10,000-year-old ice and lots and lots of fun.

**The cost is \$4999 for this 12-day workshop  
Feb 2 – 13, 2022**

The price includes:

- Bob Fletcher & Jeff Swinger as your photo guides
- Local Iceland Guide (so we don't get lost!)
- All transportation including pick-up and drop-off at the airport  
(Super 4x4 vehicle with 46" tires)
- All accommodations (double occupancy, single occupancy is \$800 additional)
- Breakfast
- Ice Cave Tour with all safety equipment & crampons
- Image Review and Post Production lessons,  
as time is available

The price does not include:

- Airfare to Iceland (around \$800 - \$900)
- Travel insurance
- Lunch & Dinners
- Gratuity to our Iceland guide & driver

If you have any interest in going or have questions,  
please call or e-mail me.

[rrfletcher@gmail.com](mailto:rrfletcher@gmail.com)

Cell: 951 202-4179

I am only taking 12 people on this workshop and I anticipate the slots booking quickly.

Bob Fletcher  
Jeff Swinger



## Here's What I Think!

This article covers different Adobe **Photoshop/Lightroom** tips and techniques. The views expressed in this article are those of the author and do not necessarily reflect the views of Redlands Camera Club.

By John Williams

**Need help?** If you have any questions about processing an image using Adobe Lightroom or Photoshop, email me at [jhwr@earthlink.net](mailto:jhwr@earthlink.net) (for RCC members only) and I will try to assist you.



## PHOTOSHOP TIPS

### Gradient Adjustment Layer:

- Photoshop 2020 has changed the Gradient Adjustment. The big difference is the Preset Gradients are located under Folders by color (see figure below). If you want to see the gradients like the old Gradient Editor, then click on the first color, hold down the Shift key, and click on the last color gradient. Then move to the very top of the popup dialog and release your mouse. This will allow you to build a gradient palette.

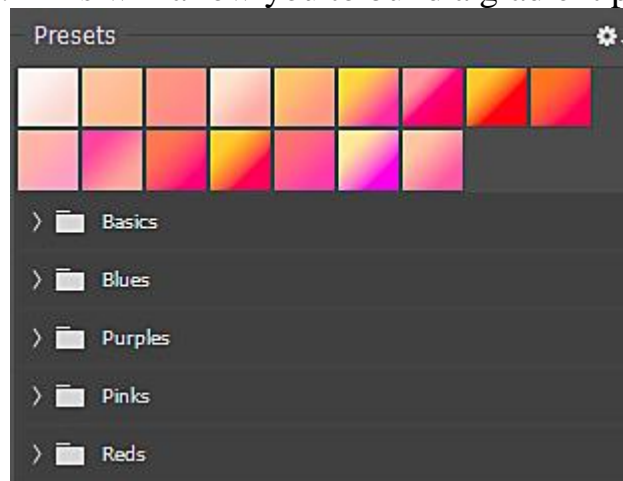

### Change the Defaults settings of the Gradient Editor:

- To launch the Gradients window go to **Window>Gradients** (see figure below).
- Next click on the menu icon (four horizontal white line icon — red arrow in figure below) located in the top right of window.
- Recommend you select **Small Thumbnail** to see more gradients in the palette, **Show Resents** (gradients will be shown along top) and the **type of Gradient** you want (Linear Gradient is most cases).

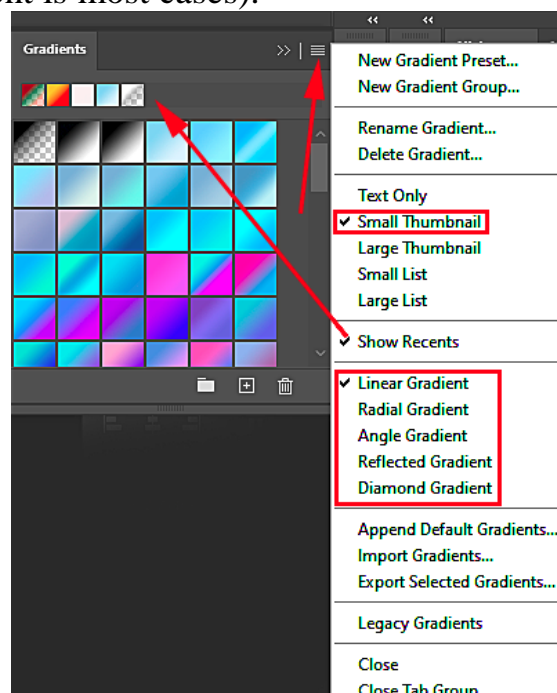

### Get back the old Save As command:

- Go to **Preferences>File Handling** tab. This will open the dialog shown in the figure below



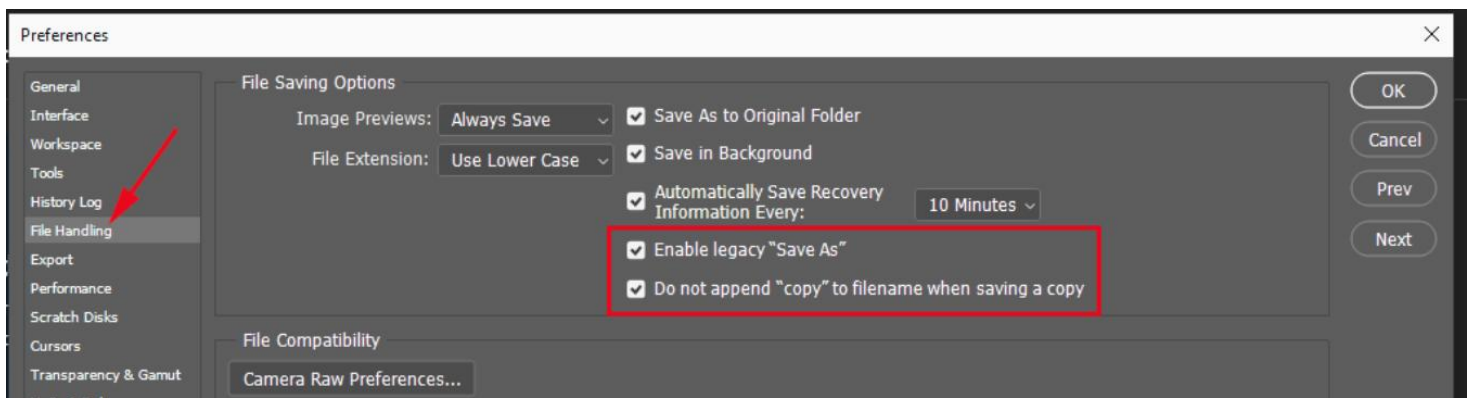

- Check Enable legacy “Save AS” and do not append “copy” to filename when saving a copy.

### Get Photoshop to guess at what font was used in any scanned image that contains text.

- Open the image in Photoshop and select the Rectangular Marquee Tool. Use this tool to select the area of an image that contains text you want to match.
- From the toolbar, choose **Type>Match Font**. A rectangle will be placed on your screen. Resize the rectangle to cover three lines of text. After you place the Match Font Selection Box closely around the text, Photoshop displays automatically list fonts similar to the font in the image, including fonts from Type kit.

Open the image in Photoshop. If the type is a little distorted then you may want to adjust it before trying to match the font. Simply duplicate the background layer in the layers panel then use the Edit > Transform > Distort function to adjust the typography and any distortion that has occurred when taking the photo. You may wish to drag guides on to the document to help with this. You may also wish to clean up the background surrounding the type at this point.

Once you're happy with the look of the type, simply use the rectangular marquee tool to draw a box around the type that you want to match. This will work best if you keep the selection to one word or line of type, keep the selection close to the edges of where the type begins and ensure that the selection area is as clear from dust and scratches as possible.

Choose from the matched fonts already installed on your machine, or download from Type kit by clicking the cloud icon.

To see the Type set matches, make sure that you have an internet connection and that you're signed into Adobe Creative Cloud. You'll also need to make sure that “Add fonts from Type kit” is elected from the Fonts tab found within the assets tab in the Adobe Creative Cloud desktop app.

Now simply choose one of the suggested fonts, draw a text box and start typing.

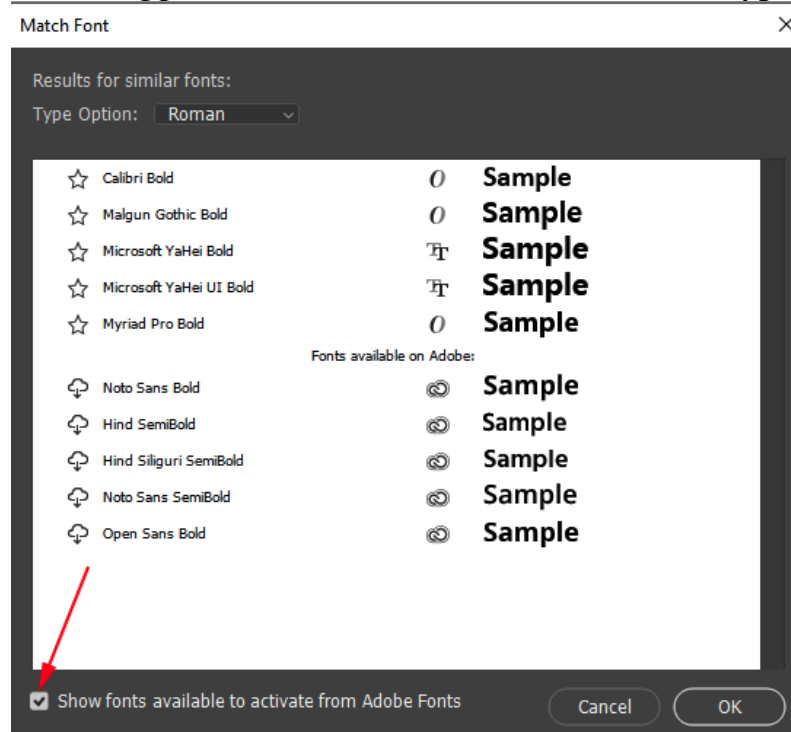

## LIGHTROOM TIPS

### Scott Kelby's seven Lightroom processing steps:

1. **Assign a RAW profile:** Click on the *Profile browser icon* (red arrow in figure below). Hover your mouse over the different profiles and select the best profile. Normally you will select Adobe Color or Adobe Landscape.

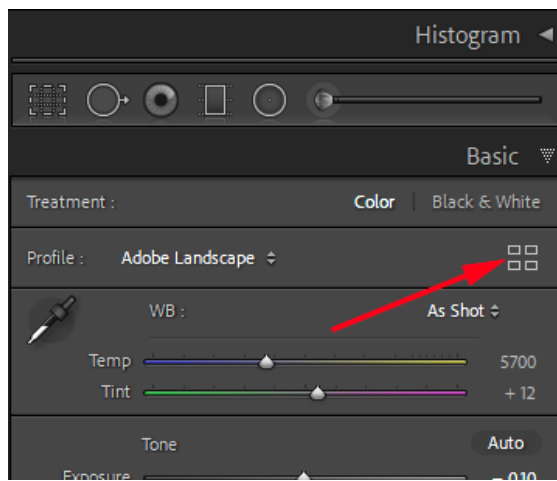

2. **Get the Color right:** This step sets the *White Balance* (3-ways). (1) You can select one of the profiles from the drop-down list such as Auto, As Shot, Daylight, etc. (2) You can also select the White Balance Selector Tool (eyedropper) and click on a neutral color. (3) Finally, you can adjust the Temp and Tint sliders.
  3. **Expand the Tonal Range:** This step sets the *White Balance*. Hold down the Shift key and double-click on the word White and Black. You will notice that the Histogram will expand across the entire tonal range and remove spikes at either end.
  4. **Deal with Sensor Limitations:** One of the problems you may experience is a washed-out sky. To get a better-looking sky move the *Highlight slider to -100*. Also, to further adjust the sky, use the Graduated Filter over the sky. You can adjust the Temp slider to make the sky bluer. If the Graduated Filter adjusts landscape areas, use the Range Mask set to Luminance and move the Range slider to the right.
  5. **Painting with Light and Retouching:** Select the *Adjustment Brush* and move the **Exposure slider** to the right (increases midtones). Paint over dark areas. Note: In Local Adjustments, dragging the Saturation slider on the plus side [dragging right] is **vibrancy** and minus [dragging left] is **desaturation**.
  6. **Fix Lens issues:** First thing to do is *straighten objects* using the Lens Correction panel and check the Enable Profile Corrections box. Next open the *Transform panel* and click on the **Auto button**. If the two automatic corrections don't correct leaning objects, then take your photo into Photoshop (**Ctrl+E**). Make a selection of the leaning object and duplicated the selection on its own layer (**Ctrl+J**). Then select Free Transform (**Edit>Free Transform or Ctrl+T**). Right-click inside the selection and in the popup, menu select **Warp**. Pull one of the top control points straight up until the object is straight. To make the cutout blend better with the background, add a *Mask* and paint with a Black brush. Note you may need to align the straighten object using the *Move Tool*.
  7. **Finishing moves:** Sharpen the image using the Detail panel. For RAW images the default amount is 40 which is normally not enough. For JPEG images the default amount is 0 since the camera software will add sharpening. Be sure to zoom into the image by 100% when sharpening and when adding too much sharpening it can cause halos. Another finishing move is to add a vignette. In the Effects panel move the Amount slider to **-11**.
- **Centered Crop Overlay**
    - There may be times when you want a photo to be cropped on a centered crop.
      1. Select the Centered Crop Overlay by choosing **Tools>Crop Guide Overlay** and in the popup menu select **Center**.
      2. OR press **O** on your keyboard to cycle through the other overlays until the Center crop overlay appears.
      3. Note: If there are overlays you don't want to see (or see), choose **Tools>Crop Guide Overlay** and in the popup menu select **Choose Overlays to Cycle** option.
    - When you crop, I recommend you do the following:

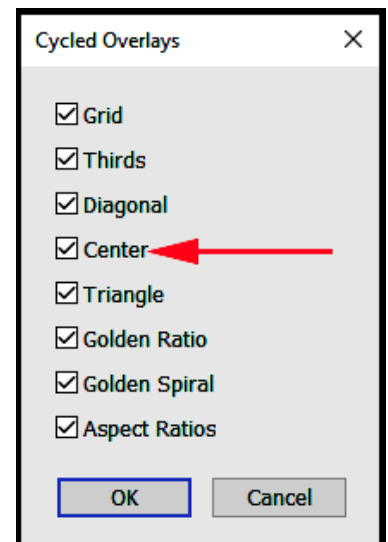

1. Hide all the panels by depressing the **Shift+Tab** keys on your keyboard.
  2. Enable Lights Out by depressing the **L** key twice.
  3. With the Centered Overlay showing, hold down the Alt key (Mac: Shift Option) and click and drag a corner towards the center. All four corners will move inward simultaneously.
- **To Level your photo:** Move your cursor outside of your photo and the cursor turns into a double-headed arrow. Then drag the cursor either up/down to rotate the photo. As you start to rotate the photo, the overlay changes to a Grid to assist you in leveling.
- 



*Photos by John White*

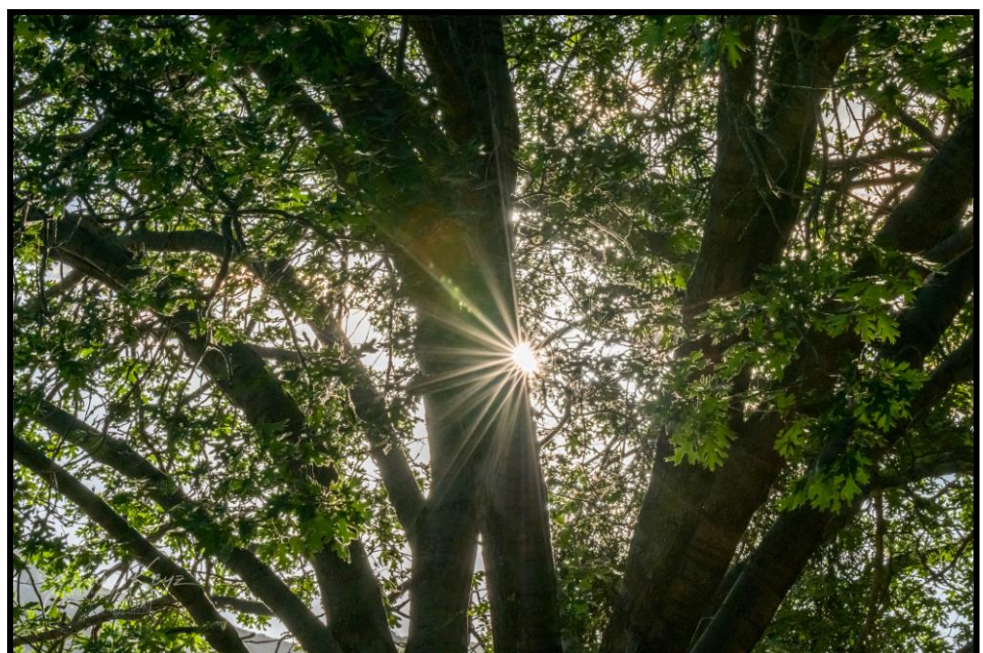

## S4C Chair – Deborah Seibly



The annual banquet announcing End of Year awards will be held virtually on September 18th.

Please go to the website to register. The first competition of the 2021-2022 year will open on October 17th and close on November 7th. Judging will take place remotely on November 14th.

*Photos  
by  
John White*





## Membership Chair – Stephanie Billings

Welcome Back,

For all our members who have not renewed their memberships due to COVID19 we have great news, WE'RE BACK!!

If you haven't already paid your dues, your Membership for 2021-2022 is now past due!

During these trying times we appreciate and thank everyone who renewed their membership. Now that we have ventured towards live meetings you will be able to pay your dues at our once-a-month meeting at the church.

But why wait until then, if you haven't already done so, please visit the RCC web site – [www.redlandscameraclub.com](http://www.redlandscameraclub.com) where you can pay directly through PayPal.

If you feel more comfortable doing it the old fashion way, you can click on the Downloads tab and print out a Membership Application. Complete all the information and mail your dues to the address listed on the form.

**Please remember that you must be a current paid member to take part in RCC classes, events, free workshops, and competitions.**

Hope to see you soon!

*Photo by Debra Dorothy*

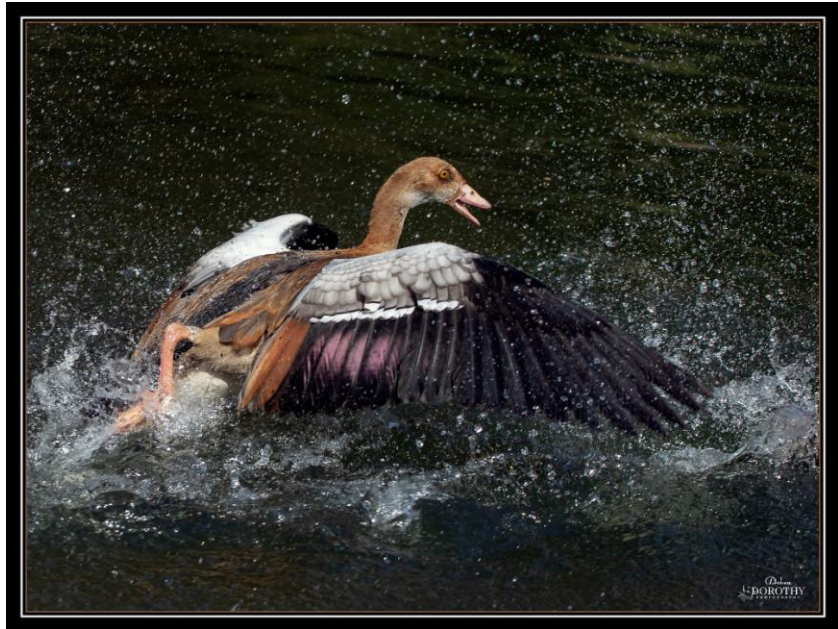

*Photo by Stephanie Billings*

# Announcements

## *New – Personal Lightroom Coaching with John Williams*

Contact John Williams for some over-the-shoulder coaching in photo editing, a great way to learn. Using your selected images, John will work with you at your level to improve your understanding of key tools and techniques to make the most of your photos. John is a regular contributor of articles on Lightroom and Photoshop to the RCC Photogram. Reach John at [jhwr@earthlink.net](mailto:jhwr@earthlink.net) or talk to him at our meetings.

## **RCC Members: Unique opportunity to make a difference**

Frank Peele, Education/Workshops Chair

### Museum of Redlands

This newly-established museum needs quality photography of items in its collection, and has asked RCC for support. This sounds like a win-win situation, both for the museum and for our members who want to develop skills in “product” photography. I envision a workshop to teach the fundamentals, and one or more shooting sessions to get into creating great images for the museum’s use. If you’re interested in being part of this service to the community, or just want to find out more about the opportunity, shoot me an email: [educationworkshopsrcc@gmail.com](mailto:educationworkshopsrcc@gmail.com) Thanks, Frank

---

## **Film cameras and Lenses Needed**

A group of photo-enthusiasts at Riverside Community College needs FILM cameras and lenses to use in their studies. If you have such equipment you’re willing to donate to a worthy cause, please contact RCC member Constance St Jean and let her know what you have. **Contact her by email at [constancestjean@gmail.com](mailto:constancestjean@gmail.com)**

---

A 35 mm slide and negative digitizer, a Wolverine F2D, has been generously donated to the club by member Dave Knapp. It will produce a 7 mb JPEG digital image from your black and white and color slides and negatives. If you are interested in borrowing it from the club, email Wayne Purcell at [waynepurcell72@gmail.com](mailto:waynepurcell72@gmail.com) or text him at (909) 664-4365.





In January the Redlands Camera Club lost one of its most memorable and valued members and a friend to all of us, Wayne (Woody) Wood. Woody loved all aspects of photography, whether on the ground or in the air, and was always getting new and exciting equipment (ooh, okay, toys).

As a consequence, this has left Woody's widow, Meredith, with equipment she can't use. She has asked me to sell Woody's equipment for her and hopes our members will help find good homes for Woody's toys.

The following is the first group of items. The prices listed are negotiable but I feel they are reasonable as they represent a discount below the same or similar items, I saw on Ebay. I believe all are in good working order.

If you would like to provide a home for any of Woody's toys, please contact me at 909-793-9300 Bruce Bonnett



**Skydio R1 Autonomous Drone 4K Flying Camera with 3 batteries and case**

**\$400**



**Lilliput 665gl-70np/ho/y 7" On-Camera HD Color LCD Field Monitor w/HDMI In HDMI Out Component in Video in Video Out by Lilliput and 2 batteries**

<https://www.amazon.com/Lilliput-665gl-70np-Camera-Monitor-Component/dp/B005VH0UMU>

**Specifications**

Panel Size:	7" TFT LCD (16:9)
Resolution:	1024x600, up to 1920x1080
Brightness:	250cd/m <sup>2</sup>
Contrast:	700:1
Viewing Angle:	150°/ 145°(H/V)
Input Voltage:	DC 6-24V (XLR DC Connection)
Input Signal:	HDMI, YPbPr, AV, HD-SDI (optional)
Current:	650mA
Standby Current:	50mA
Power Consumption:	7.8W
Size(LWD):	194.5x150x38.5mm/112.5mm (with sun shade)
Weight:	584g / 700g (with sun shade)

**\$75**



**LINKSYS WIRELESS-G  
2.4Ghz. ROUTER with  
SRX200**

**\$25**



**Promaster 1725N  
Camera Bag**

**\$10**





**LoweproCompuDaypack  
Camera Bag**

**\$30**



**Lowepro Inverse 200 AW  
Camera Beltpack**

**\$40**



Top and left are for Mavic Drones  
 Bottom right is for Skydio R2  
 \$10



Ultimaxx DRONE BACKPACK STRAP VEST



\$20



**MSI R9 390 8GB Video Card**

**\$175**



**iMax X100 AC/DC Touch Screen Balance Charger**

**\$50**

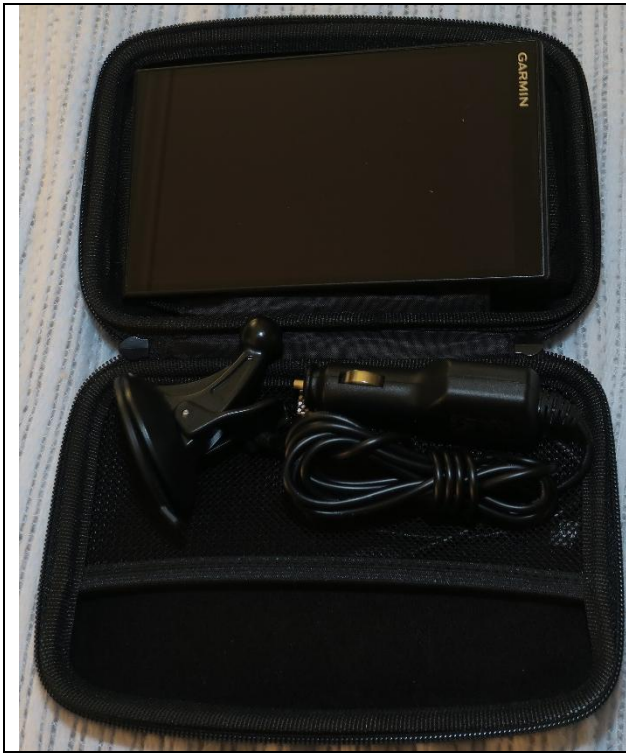

**Garmin rv 770 GPS  
with 6.945" edge-to-  
edge screen and RV  
specific features.**

**\$300**



**GoPro/Action  
CamsMisc Bag 1  
\$15**





**Pano 5+1 Mark II – Panoramic Photo Head Compatible with GoPro Hero 7/6/5/4/3**

**\$20**

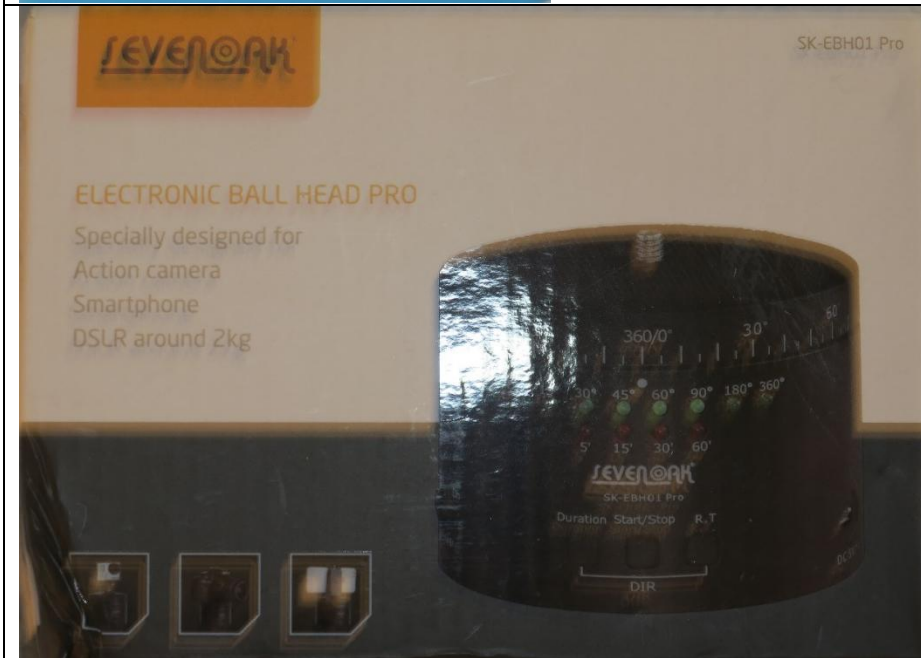

**Sevenoak SK-EBH01 Pro Electronic Time Lapse/Panoramic Ball Head**

**\$75**



## Photogram Editor – Debra Dorothy



### A Note from The Photogram Editor

The theme for the October Photogram is:

**“Architecture Inside or Out”**

Please send your images to me by September 25<sup>th</sup> to have them included in the October Photogram for all to enjoy.



<mailto:debbiedsd.dorothy@gmail.com>

Redlands Camera Club P.O. Box 7261 Redlands Ca 92375

<http://www.redlandscameraclub.org/>

Officers (2020-2021)

President: Russell Trozera – Vice President/Program’s: Donald Purdey – Secretary: Deborah Seibly –  
Treasurer: Rick Strobaugh – Past President: Dave Ficke

Chairs (2020-2021)

Competitions: Carl Detrow – Education/Workshops: Frank Peele – Facebook/Blog: Stan Fry – Field  
Trips: Pending – Historian: Bruce Bonnett – Hospitality/Events: Pending – Librarian: Michael  
Graves – Membership: Stephanie Billings – Mentor: Rick Strobaugh – Photogram: Debra Dorothy –  
Publicity: Stan Fry – S4C: Deborah Seibly – Color Munki: Carl Detrow – Webmaster: Wayne  
“Woody” Wood/Debra Dorothy – Welcome: Stephanie Billings